

Other HEMCO Products



UniFlow CE
AirStream



UniFlow SE AireStream
High Performance
Energy Efficient
Laboratory Fume Hood



UniFlow LE
AirStream



UniFlow LE FM



Safety Equipment



Visit www.HEMCOcorp.com

HEMCO Corporation
711 S. Powell Road
Independence MO, 64056
MM-SAFETYSTATION-04.23

HEMCO
Lab Planning Solutions

Phone (816) 796-2900
Fax (816) 796-3333
Email info@HEMCOcorp.com

Installation, Operation, Maintenance Manual

Safety Station



HEMCO Visit www.HEMCOcorp.com
Lab Planning Solutions

HEMCO Corporation
711 S. Powell Road
Independence MO, 64056

Email info@HEMCOcorp.com
Phone (816)796-2900
Fax (816)796-3333



Safety Station Installation Manual

Notes:

Assembly and Installation Instructions

Attachment to Floor - Mounting hardware is Not included (supplied by others)

Caution: Check for Adequate Floor Strength

Concrete: Secure the floor flange (stainless steel or galvanized steel) using four (4) expansion anchors or equivalent type anchors. Note: If a concrete base is required, ensure raised area is no more than 2" from standing level.

Metal: Secure floor flange using four (4) 1/2 - 13 UNC machine bolts and nuts for thick metal surface (drill and tap thick metal surface), or four (4) 1/2 -13 bolts and nuts for thin metal surface. Bolts should be long enough to allow at least a 1/2" bolt clearance for nut attachment.

Wood: Secure floor flange using four (4) 1/2" X 3" lag screws

NOTES:

- See figure 1 Installation layout for reference.
- The use of a pipe wrench and appropriate pipe sealant are required for proper attachment of each component, unless otherwise noted.
- If an obstruction exists which may prevent assembly of the overhead shower section to the upper stanchion, complete steps 1 - 8 (below) prior to mounting the floor flange to the floor.
- Floor flange should be positioned with the waste connection facing away from standing area of user.
- When floor flange is secure, check flange to ensure correct installation and no movement of the flange is present.

f. NOTE: AT THIS TIME DO NOT INSTALL

- Shower head and street elbow to overhead pipe.
- Eye wash control and bowl from union bowl connection.

- Locate plumbing assembly in desired location, verify clearance dimensions and mount to floor with fasteners suitable for floor materials.

1. Once placement and installation of the floor flange is complete, assemble the 1 1/4" tee to the floor flange. Waste connection should be properly located to rear or desired side away from standing area of user.

2. Assemble the lower stanchion (22") to the tee fitting.

3. Do one of the following according to the type of upper stanchion (one piece or three piece) **One Piece:** Assemble upper stanchion (57 1/2") to the plugged adapter. **Three Piece:** First assemble the bottom half of upper stanchion to the plugged adapter. Then assemble the coupling to the bottom half (28 1/2") of the upper stanchion to the coupling.

4. Assemble the overhead shower assembly 1 1/4" tee to the upper stanchion.

5. Align the overhead shower assembly with the fountain section.

6. Attach shower head to the overhead shower elbow, taking care not to cross thread. Hand tighten until snug.

CAUTION: Do not overtighten, Pipe sealant or tape is not required or recommended.

7. Remove cotter pin and washer from the pull rod and insert tip through the hole at the end of the shower actuation arm. Tip of pull rod should be on the actuator arm side closest to the overhead piping. Reattach washer and cotter pin to secure pull rod.

8. Remove access plate from cabinet assembly. Slide cabinet assembly back to plumbing assembly. Place access plate over eyewash union. (continued on next page)

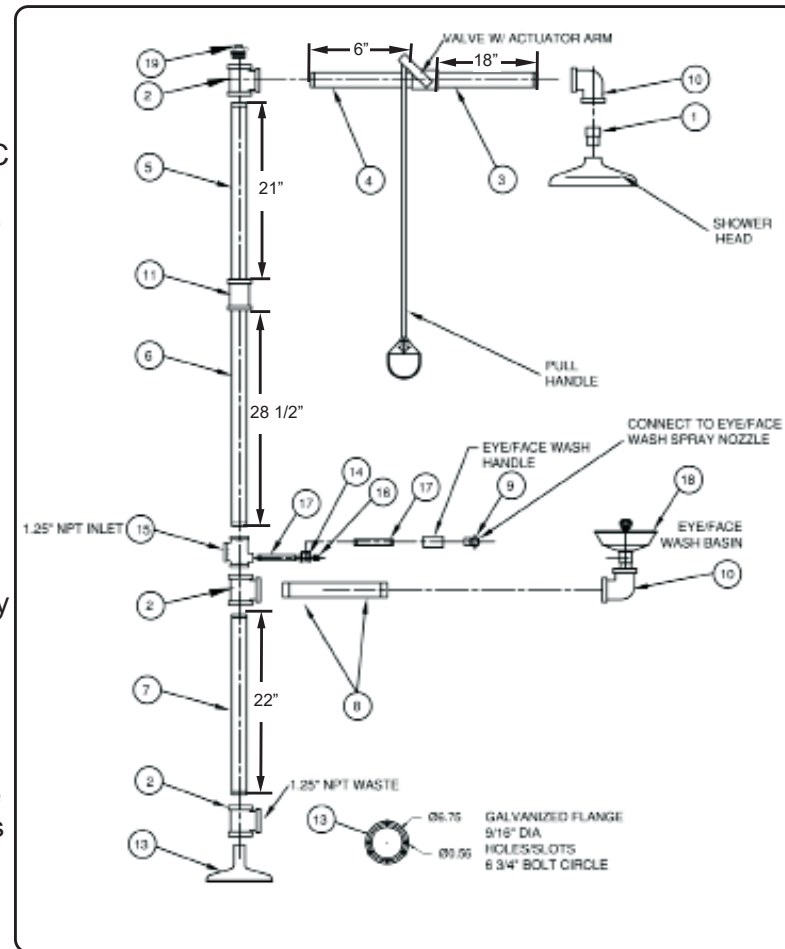

figure 1

Safety Station Installation Manual

OPERATION & MAINTENANCE

1. Plumbed units shall be activated weekly to flush lines and verify proper flow pattern and volume.
2. If freeze or scald protection is included with your unit, the valves should be inspected each year, and cycled before hot or cold weather sets in.
3. Test records should be maintained verifying compliance with testing procedures.

GENERAL INFORMATION

Following are requirements of ANSI Z358.1 for Emergency Eyewash and Shower Equipment. A complete copy of the standard may be purchased from the International Safety Equipment Association.

1. Unit shall be installed in accordance with the manufacturer's instructions and acceptable plumbing practices.
2. The height of the shower head shall be not less than 208.3 cm (82 inches) nor more than 243.8 cm (96 inches) from the surface on which the user stands.
3. The eye/face wash shall be positioned with the water nozzles between 83.8 cm (33 inches) and 114.3 cm (45 inches) from the floor and 15.3 cm (6 inches) minimum from the wall or nearest obstruction.
4. The unit shall be connected to a system capable of supplying adequate flushing fluid to meet the flow requirements of each component operating simultaneously. The supply line shall provide an uninhabitable supply of potable water at a recommended minimum 0.207 mega pascal (30 pounds per square inch) of flow pressure.
5. Where the possibility of freezing conditions exists, equipment shall be protected from freezing or freeze protected equipment shall be installed.
6. When a shower is installed, it shall be tested in accordance with the following procedures:
 - a. With the unit correctly connected to the water source and the valve(s) closed, visually check the piping connection for leaks.
 - b. Open the valve to the full open position. The valve shall remain open without requiring further use of the operator's hands.
 - c. With the valve in the "full on" position, measure the diameter of the spray pattern. It shall be a minimum of 50.8 cm (20 inches) at 152.4cm (60 inches) above the standing surface. The center of the spray shall be at least 40.6 cm (16 inches) from any obstructions.
7. When the eye face wash is installed, it shall be tested in accordance with the following procedures:
 - a. With the unit correctly connected to the water source and the valve(s) closed, visually check the piping for leaks.
 - b. Open the valve to the full open position. The valve shall remain open without requiring further use of the operator's hands.
 - c. With the valve in the "full on" position, measure the flushing fluid flow pattern with the use of a test gauge to determine a suitable eyewash pattern as required by ANSI standards. Determine that both eyes can be irrigated simultaneously at a velocity low enough not to be injuries to the user.

NOTE: Test that all devices on combination units are capable of operating simultaneously to ANSI standard.
8. Shower units shall be in accessible locations that require no more than 10 seconds travel time from the farthest hazard.
9. Each unit location shall be identified with a highly visible sign. The area around the unit shall be well lit.
10. Plumbed units shall be inspected annually for proper operation to ensure compliance to ANSI Z358.1 standard.

TRAINING

All employees who might be exposed to hazardous material shall be instructed in the location and proper use of emergency shower and eye/face wash units. Experiences have shown that initial first aid treatment for irritants should be to wash the eyes and face for 15 minutes prior to medical treatment. It is important to hold the eyelids open and roll the eyes so water will flow on all surfaces and in the folds surrounding the eyes.

WARRANTY STATEMENT

Seller warrants title, materials, and workmanship on equipment, except components manufactured by others for which the Seller assigns, as permitted, the original manufacturer's warranty. Seller's warranty shall be for a person of (1) one year from the date of sale to the ORIGINAL CONSUMER PURCHASER, during which non-conforming equipment returned to the Seller at Buyer's expense and risk, will be repaired or replaced at the Seller's option. HEMCO Corporation will repair or replace products found to be defective in materials or workmanship within the period set forth above, provided that: (a) the product has not been subjected to abuse, contamination, neglect, accident, incorrect wiring, not our own, improper installation or servicing, or used in violation of instructions furnished by HEMCO Corporation. and (b) as to any prior defects in materials or workmanship covered by this warranty, the product has not been repaired or altered by anyone except for HEMCO Corporation, and (c) the serial number has not been removed, defaced or otherwise changed, and (d) examination discloses, in the judgement of HEMCO Corporation, does not assume the costs of removal and/or installation of the product or any other incidental costs of removal and/or installation of the product or any other incidental costs which may arise as a result of any defect in material or workmanship, and (e) upon discovery of defect, Buyer shall immediately cease use of and notify HEMCO Corporation.

Any warranty implied by law, including warranties of merchantability or fitness, is in effect only for the duration of the expressed warranties set forth above, no person is authorized to give any other warranty, or to assume for HEMCO Corporation any other liability in connection with the sale of its products; HEMCO Corporation shall not be liable for the loss of use, revenue, or profit or for any injury, or for any other consequential or incidental damages, buyer is not relying on seller's judgment regarding his or her particular requirements, and has had an opportunity to inspect the product to his or her satisfaction.

This warranty gives you specific legal rights, and you may also have other rights, which vary, from state to state.

Safety Station Installation Manual

Plumbing on safety station is numbered, for re-assembly

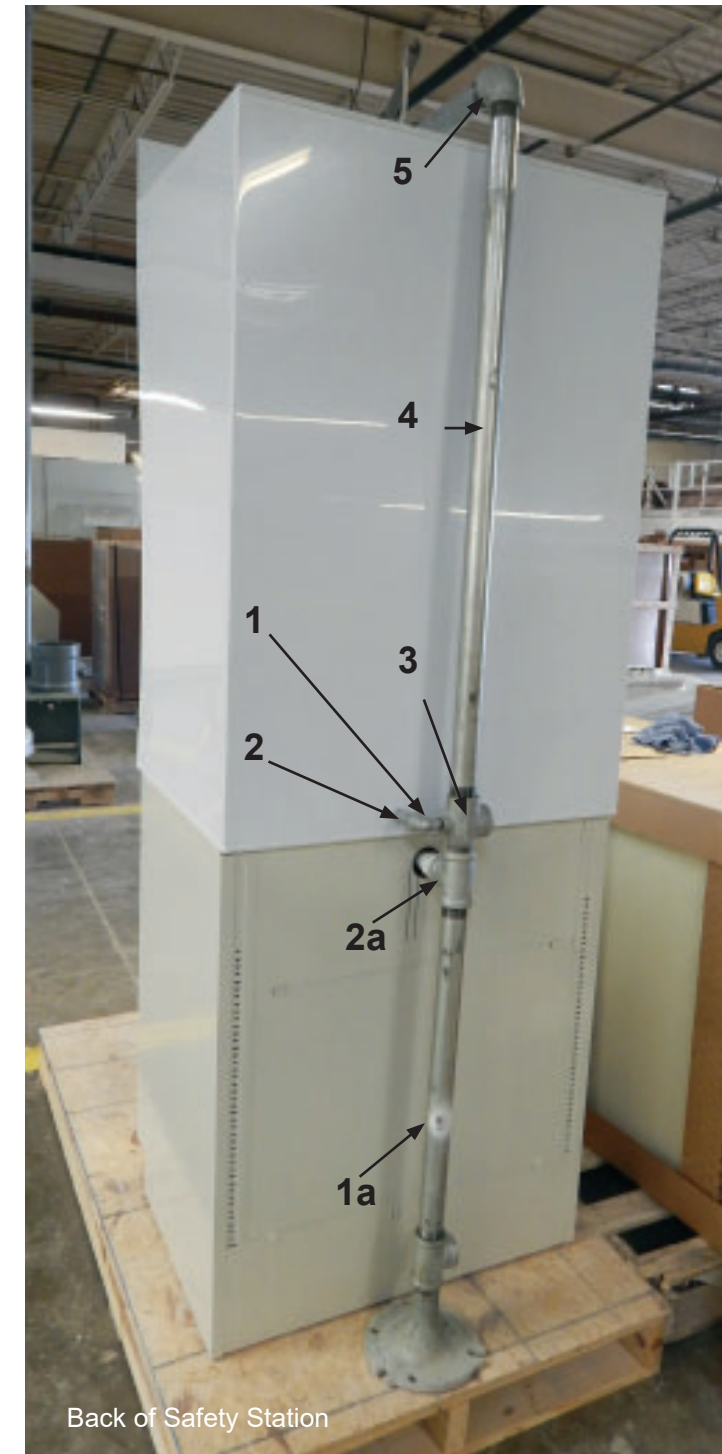

1. Street Elbow, connects supply to #2
2. Pipe connects to eye /face wash inside of safety station
3. Connects to supply
4. Pipe to top of station
5. Elbow
6. Pipe into valve actuator
7. Pipe to Drench shower on front top of safety station
- 1a. Floor flange, and pipe
- 2a. Tee connects to 1-1/4 P-trap inside of cabinet

Safety Station Installation Manual

Front of safety station

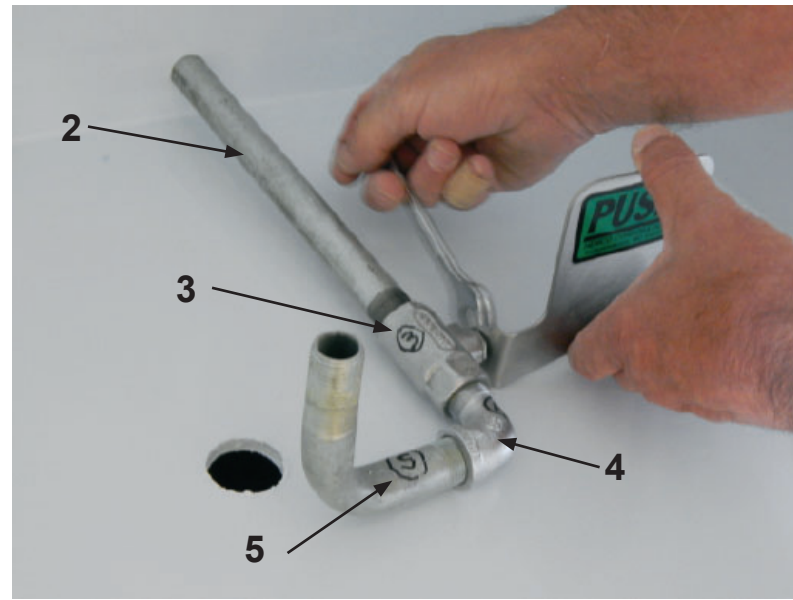

- 2. Pipe connects to eye /face wash inside of safety station
- 3. Push valve
- 4. Elbow
- 6. Pipe into eye / face wash



Install Push pull handle onto valve #3 using nut provided



Safety Station Installation Manual



P-Trap inside of cabinet, connects to bottom of eye / face wash, and out back of cabinet to elbow 2a.



Hardware for cabinet is located inside bottom of cabinet, includes door pulls, and shelf supports.

